

**REIMBURSEMENT AGREEMENT  
BETWEEN  
CITY OF MURRIETA, CALIFORNIA  
AND  
EASTERN MUNICIPAL WATER DISTRICT  
FOR  
EMWD FACILITY ADJUSTMENTS FOR MURRIETA HOT SPRINGS ROAD  
PAVEMENT REHABILITATION PROJECT, CIP 13047**

**THIS AGREEMENT** is made and entered into as of \_\_\_\_\_, between the CITY OF MURRIETA, California, a municipal corporation, hereinafter referred to as "CITY" and EASTERN MUNICIPAL WATER DISTRICT, a municipal water district organized and operating pursuant to the Municipal Water District Law of 1911 as set forth in the California Water Code, hereinafter referred to as "EMWD." In consideration of the mutual promises and covenants contained herein, the parties hereto mutually agree as follows:

**Section 1. Purpose.** The purpose of this Agreement is to establish reimbursement to CITY by EMWD for the cost of adjusting EMWD facilities (manholes) as shown on the attached plans which are made part of this Agreement as Attachment "A", in conjunction with the improvement of the Murrieta Hot Springs Road Pavement Rehabilitation Project, CIP 13047, hereinafter referred to as "PROJECT". Existing manholes owned by EMWD must be double adjusted to grade as part of the PROJECT. The facilities to be adjusted are within the CITY's right-of-way. Pursuant to this Agreement, EMWD agrees to pay for the adjustments of the manhole facilities that are located in the CITY's right-of-way and are related to the PROJECT.

**Section II. Bid Items.** EMWD shall reimburse CITY one hundred percent (100%) of the costs (hereinafter referred to as "REIMBURSEMENTS"), for the adjustments of certain EMWD facilities within the PROJECT area, as detailed in the table below. The costs for the REIMBURSEMENTS to CITY by EMWD shall include those facility items as shown on the attached plans in Attachment "A" and as stated on the Bid Sheet, which are made a part of this Agreement. The estimated costs for the bid items on the Bid Sheet ("Bid Items") are provided below based on the engineer's estimate for the PROJECT. EMWD shall reimburse the City using the actual bid prices provided by the Bid Sheet plus the cost of any EMWD-approved change order(s). The estimated costs for the bid item on the Bid Sheet are provided below based on the engineer's estimate for the PROJECT.

**TOTAL ESTIMATED PROJECT BID ITEMS FROM ATTACHMENT "A"  
(EMWD's responsibility)**

Item:	Item	Estimated Quantity	Estimated Unit Cost	Estimated Ext Amount
43	Double Adjust Existing Manholes to Grade Per EMWD Std. SB-8, SB-53, & SB-61.	25 EA	\$2,280.00	\$57,000.00
Contingency (10% of Subtotal)				\$5,700.00
Total Estimated EMWD Reimbursements to City:				\$62,700.00

**Section III. Construction and Costs.**

a. **Bidding.** Costs for the construction are based upon the construction bids that will be received for the PROJECT for the Bid Items referenced in Section II as shown on the Bid Sheet

for the PROJECT. CITY will evaluate and analyze all bids received and select the lowest responsible bidder for the PROJECT (hereinafter referred to as "CONTRACTOR"). Per EMWD requirements, the CITY agrees that the bid package will require the CONTRACTOR who will perform work on the water items shall have either an "A" or "C34" Contractor's License.

b. **EMWD Right to Perform.** To provide EMWD the option to perform the work identified at Section II as work that is EMWD's responsibility, the CITY's construction bid package shall identify EMWD's Bid Items as Additive Bid Items. Upon receipt of the bids and determination of the lowest responsive and responsible bidder for the PROJECT, the CITY shall notify EMWD of its identified portion of the construction costs for the Bid Items. At that time, EMWD may elect to perform/construct the Bid Items itself to the same specifications as described in the bid specifications. If EMWD elects to perform the Bid Items, EMWD shall bear all costs associated with that work and the CITY shall not include said Bid Items in the contract with the CONTRACTOR. EMWD shall be given a "construction window" inside the PROJECT traffic control to complete the manhole adjustments. Moreover, EMWD shall bear all costs associated with the manhole adjustments, included but not limited to, delay to the CITY'S CONTRACTOR or utility coordination efforts needed as a result of having multiple contractors on site. EMWD shall provide written notice to the City Engineer of its determination to perform the Bid Items within fourteen (14) calendar days from the date of receipt of the CITY's identification of its lowest responsive and responsible bidder or EMWD waives any right to construct the Bid Items.

c. **Payment.** EMWD shall maintain a contingency amount equal to ten percent (10%) of the total estimated costs of the adjustment of the sewer facilities to account for unforeseen changes to the PROJECT. The CITY shall obtain written approval from EMWD prior to the approval of any change orders associated with the adjustments of the facilities EMWD is financially responsible for and authorize the CONTRACTOR to proceed unless failure to act immediately may affect public safety. The cost of any delay in the work due to the delayed action of EMWD in connection with PROJECT construction shall be borne by EMWD. EMWD shall respond to any PROJECT change orders within fourteen (14) calendar days.

CITY shall make payment to CONTRACTOR for all work performed. Actual costs shall be identified and billed to EMWD for payment on the following basis:

The CITY shall invoice EMWD using progress payments or upon completion of the PROJECT, at the discretion of the CITY, for all Bid Items that are the financial responsibility of EMWD. EMWD shall remit payment to the city within thirty (30) days of receipt of the approved invoice or the invoices shall accrue interest of 5% per year compounding monthly.

#### **Section IV. Plans, Permits and Contacts.**

a. **Plans and Specifications.** EMWD acknowledges that it has reviewed and approved all plans and specifications for the adjustments of the sewer facilities as shown on the attached plans and the estimated bid amounts are reasonable.

b. **CEQA.** The CITY shall be responsible for obtaining any and all environmental permits and approvals as may be necessary for the PROJECT including, but not limited to, compliance with requirements imposed under the California Environmental Quality Act ("CEQA") as may be applicable.

c. **Agreement Management.** Management and administration of the terms expressed herein shall be performed by CITY for the PROJECT. CITY designates **Mr. Jeff Hitch, City**

**Engineer**, as the contact for CITY in regard to this Agreement. EMWD designates **Mr. Armando Arroyo, Director of Development Services**, as the contact for EMWD to facilitate the REIMBURSEMENTS identified herein.

**Section V. Inspection.** EMWD shall be responsible to inspect the construction of all EMWD facilities, as shown on Attachment "A" and described in Section II of this Agreement, and the performance of the involved work by CITY's CONTRACTOR for compliance with the approved construction plans and specifications and/or for EMWD's own work if such work has been undertaken by EMWD pursuant to Section III(b). EMWD's inspection personnel shall have the authority to enforce EMWD's construction plans and specifications for the PROJECT, which authority shall include the authority to require that any and all unacceptable materials, workmanship, and/or installation be replaced, repaired, or corrected by CITY's CONTRACTOR without cost to EMWD.

If EMWD undertakes the performance of the PROJECT's Bid items shown in Section II under Total Estimated Project Bid Items From Attachment "A," and if, through the failure of EMWD to provide access and control of the construction site within the time allotted by the Project Specifications, the CITY's CONTRACTOR sustains loss which could not have been avoided by the judicious handling of forces and/or equipment, EMWD shall be liable for that part of the CITY's CONTRACTOR's actual loss, that was unavoidable in accordance with State of California, Department of Transportation Standard Specifications section 8-1.09, RIGHT-OF-WAY DELAYS.

**Section VI. Insurance and Indemnity.** For the period during which CITY or its CONTRACTOR(s) controls the job site, CITY will provide, or cause to be provided, for the entire period of construction, a policy of workers' compensation insurance and comprehensive general liability insurance with coverage broad enough to include the contractual obligation it may have under the construction contract and having a combined single limit of liability in the amount of \$2,000,000 covering EMWD's officers, employees, and agents as additional insureds.

If EMWD undertakes to perform the PROJECT's Bid Items shown in Section II under Total Estimated Project Bid Items from Attachment "A" pursuant to Section III(b), EMWD, prior to commencement of the work and for the period during which EMWD operates at the job site, will provide, or cause to be provided, for the entire period of construction, a policy of workers' compensation insurance and comprehensive general liability insurance with coverage broad enough to include the contractual obligation it may have under the construction contract and having a combined single limit of liability in the amount of \$1,000,000 per occurrence with a \$5,000,000 aggregate covering the CITY's officials, officers, employees, and agents as additional insureds.

EMWD and the CITY each hereby agree to indemnify, defend, and hold harmless the other party and their respective directors, officials, officers, employees and agents from and against any claims, actions, damages and liabilities arising out of or in any manner connected with any act or omission of such indemnifying party, performed in connection with such party's duties and obligations hereunder. This Clause shall survive the termination of this agreement.

**Section VII. Notices.** All notices under this Agreement shall be sent as follows:

WATER DISTRICT: EASTERN MUNICIPAL WATER DISTRICT  
P.O. Box 8300  
Perris, CA 92572  
Attn: Armando Arroyo, Director of Development Services

CITY: City of Murrieta  
1 Town Square

Murrieta, CA 92562  
Attn: Jeff Hitch, City Engineer

Either party may change its address for notices by notifying the other party. All notices given at the most recent address specified shall be deemed to have been properly given.

**Section VIII. Amendment.** This Agreement may only be amended in writing upon the mutual written consent of both parties.

**Section IX. Laws, Venue and Attorney's Fees.** This Agreement shall be interpreted in accordance with the laws of the State of California. If any action is brought to interpret or enforce any term of this Agreement, the action shall be brought in a state of federal court situated in the County of Riverside, State of California. In the event of any such litigation between the Parties, the prevailing Party shall be entitled to recover all reasonable costs incurred, including reasonable attorney's fees, as determined by the court.

**Section X. Interpretation and Headings.** This Agreement shall not to be construed against the Party preparing it but shall be construed as if both Parties prepared it. Headings to paragraph/subparagraphs of this Agreement are for convenience purposes only and are not part of this Agreement.

**Section XI. Provisions Binding.** This Agreement and the Exhibits attached hereto are binding on the heirs, representatives, successors, and assigns of the Parties of this Agreement.

**Section XIII. Authority to Sign Agreement.** The undersigned individuals hereby warrant and represent that they each have full legal authority to sign this Agreement and bind the

Parties hereto.

This Agreement is effective as of the date set forth above.

EMWD:

EASTERN MUNICIPAL WATER DISTRICT

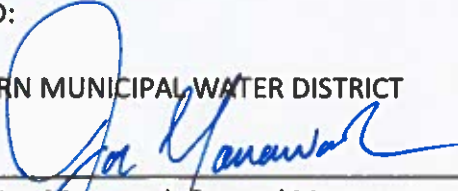
By:   
Joe Mouawad, General Manager

By:   
Sheila Zelaya, Board Secretary

APPROVED AS TO FORM:

  
Steve O'Neill, General Counsel for EMWD

CITY:

CITY OF MURRIETA

By: \_\_\_\_\_  
Lori Stone, Mayor

ATTEST:

\_\_\_\_\_  
Cristal McDonald, City Clerk

APPROVED AS TO FORM:

\_\_\_\_\_  
Tiffany Israel, City Attorney

**Attachment "A"**

**City of Murrieta Improvement Plans and Bid Sheet for Murrieta Hot Springs Road Pavement  
Rehabilitation Project, CIP 13047**

**CITY OF MURRIETA, DEPARTMENT OF PUBLIC WORKS/ENGINEERING**

**BID SHEET**

**\*\*\*This Bid Sheet defines how the project will be bid and what will constitute the Lowest Bidder. The actual unit prices and total item prices shall be submitted online on the PlanetBids Vendor Portal as defined in the Instructions to Bidders. Should there be a discrepancy between this Bid Sheet and the electronic proposal, the electronic proposal shall govern.\*\*\***

**MURRIETA HOT SPRINGS ROAD PAVEMENT REHABILITATION  
CIP 13047, CITY PROJECT NO. 24-485**

ITEM NO.	DESCRIPTION	ESTIMATED QUANTITY	UNIT	UNIT PRICE	TOTAL ITEM PRICE
1	Mobilization	1	LS		
2	Traffic Control System	1	LS		
3	Water Pollution Control	1	LS		
4	Construction Surveying and Staking	1	LS		
5	Changeable Message Signs	3	EA		
6	Project Information Sign	1	EA		
7	Furnish/Install Survey Monument per COM std. no. 617B AND 617C	4	EA		
8	Double Adjust Storm Drain Manhole	1	EA		
9	Concrete Removal (Curb Ramp, Cross Gutter, Spandrel, Curb/Gutter) at Weeping Willow Ln./Thoroughbred Ln.	3,335	SF		
10	Concrete Cross Gutters, Spandrel, and Curb per City Std. 311, 312 & 318	1,491	SF		
11	Concrete Access Ramps, City Std. 321	1,502	SF		
12	Concrete Sidewalks, City Std. 320	468	SF		
13	Concrete Removal (Concrete Curb and Gutter Murrieta Hot Springs Rd.)	50	LF		
14	Concrete Curb and Gutter (8") per City Std. 302 (Murrieta Hot Springs Rd.)	50	LF		
15	Remove and Dispose of Full Depth Structural Digout at Bridge Abutment (AC and Base)	14,950	SF		
16	Remove and Dispose of Asphalt Concrete Pavement (average depth 9.2" Digouts on Murrieta Hot Springs Road)	38,105	SF		
17	Remove and Dispose of Asphalt Concrete Pavement (average depth 4" Digouts on Thoroughbred and Weeping Willow)	700	SF		
18	Cold Milling Asphalt Concrete Pavement 2.5" to 2.75" Full Width	37,734	SY		
19	Aggregate Base for Full Depth Structural Digout at Bridge Abutment	598	CY		
20	Geotextile Reinforcement (Tensar BX1100 or Approved Equal)	1,481	SY		
21	ARHM Overlay 2.5" (0.208') Murrieta Hot Springs Road	5,094	TON		
22	Asphalt Concrete Pavement for Removal and Replacement of AC (Digouts)	2,658	TON		
23	Furnish/Install Detector Loop	84	EA		
24	Furnish and install #5 pullbox, connect DLC for traffic loops	6	EA		

**UNIT PRICES and  
TOTAL ITEM  
PRICES shall be  
submitted  
online at  
PlanetBids.com**

**CITY OF MURRIETA, DEPARTMENT OF PUBLIC WORKS/ENGINEERING**

ITEM NO.	DESCRIPTION	ESTIMATED QUANTITY	UNIT	UNIT PRICE	TOTAL ITEM PRICE
25	Furnish and install 1 1/2" conduit under sidewalk panels or as shown . Connect to existing conduit	126	LF		
26	Furnish and install DLC. Connect loops to existing traffic cabinet	5,513	LF		
27	Wet Sandblast/Remove Existing Pavement Markings on bridge deck	441	LF		
28	Pavement Striping Detail 12	12,915	LF		
29	Pavement Striping Detail 22	1,789	LF		
30	Pavement Striping Detail 25	2,893	LF		
31	Pavement Striping Detail 29	1,038	LF		
32	Pavement Striping Detail 37B	374	LF		
33	Pavement Striping Detail 38	1,348	LF		
34	Pavement Striping Detail 39	6,315	LF		
35	Pavement Striping Detail 39A	1,463	LF		
36	Thermoplastic Striping Detail 40	212	LF		
37	Pavement Striping 6" Solid White Lane Line	1,100	LF		
38	Painted Bike Lane Symbol with Person Pavement Marking and Bike Lane Arrow	192	SF		
39	Thermoplastic Pavement Marking "SIGNAL" and "AHEAD"	540	SF		
40	Thermoplastic Pavement Marking (Type IV Arrow)	399	SF		
41	Thermoplastic Pavement Marking (12" White)	1,511	SF		
42	Paint Median Nose Yellow	80	SF		
<b>TOTAL BASE BID: \$</b>					
TOTAL AMOUNT OF BASE BID (WORDS): _____					
<b>ADDITIVE BID ITEMS:</b>					
43	Double Adjust Sewer Manhole	25	EA		
<b>TOTAL ADDITIVE BID: \$</b>					
TOTAL AMOUNT OF ADDITIVE BID (WORDS): _____					
<b>SUM OF THE TOTAL BASE BID ITEMS AND ADDITIVE BID ITEM:</b>					
<b>\$</b>					
<b>SUM OF THE TOTAL BASE BID ITEMS AND ADDITIVE BID ITEM (WORDS):</b>					



**CITY OF MURRIETA, DEPARTMENT OF PUBLIC WORKS/ENGINEERING**

**Basis of the bid shall be based upon the sum of the Total Base Bid Items and the Additive Bid Item.**

The City reserves the right to reject any or all bids.

The City reserves the right to choose or reject any of the Additive Bid Items.

The unit price or lump sum prices to be paid for the items listed in the Proposal Bid Sheet shall include full compensation for furnishing all labor, materials, tools, and equipment, and doing all work involved in furnishing and installing the materials complete and in place, in accordance with the details as shown on the plans and as specified herein. Any items shown on the plans, but not included in the bid items, shall be considered as appurtenant items. All costs shall be included within the appropriate item of the Contractor's bid.

# PAVEMENT REHABILITATION PROJECT DESIGN PLANS FOR THE CITY OF MURRIETA MURRIETA HOT SPRINGS ROAD

CIP NO. 13047, CITY PROJECT NO. 24-485

**SIGNING AND STRIPING GENERAL NOTES:**

1. THE CONTRACTOR IS REQUIRED TO FACE ALL THE PRESCRIPTIONS REQUIRED FOR THE PROTECTION OF ALL UTILITIES AND STRUCTURES AND THE PROTECTION OF THE PUBLIC AND THE PROTECTION OF THE ENVIRONMENT OF THE CONTRACTOR'S WORK.
2. THE CONTRACTOR SHALL BE RESPONSIBLE FOR THE CLEARING OF THE PROPOSED WORK AREA, INCLUDING THE REMOVAL OF ALL OBSTRUCTIONS, AND THE PROTECTION OF ALL UTILITIES AND STRUCTURES AND THE PROTECTION OF THE PUBLIC AND THE PROTECTION OF THE ENVIRONMENT OF THE CONTRACTOR'S WORK.
3. TRAFFIC STRIPES, PAVEMENT MARKINGS AND RAISED PAVEMENT MARKERS PER CALTRANS STANDARD PLANS AND SPECIFICATIONS, 2009 EDITION.
4. ALL STRIPES AND MARKINGS SHALL BE PAINTED. ALL STRIPES SHALL BE PAINTED IN ACCORDANCE WITH THE SPECIFICATIONS FOR PAINTED STRIPES AND MARKINGS PER CALTRANS STANDARD PLANS AND SPECIFICATIONS, 2009 EDITION. ALL STRIPES SHALL BE PAINTED IN ACCORDANCE WITH THE SPECIFICATIONS FOR PAINTED STRIPES AND MARKINGS PER CALTRANS STANDARD PLANS AND SPECIFICATIONS, 2009 EDITION.
5. PAINTED TRAFFIC STRIPES AND PAINTED PAVEMENT MARKINGS SHALL BE PAINTED IN ACCORDANCE WITH THE SPECIFICATIONS FOR PAINTED STRIPES AND MARKINGS PER CALTRANS STANDARD PLANS AND SPECIFICATIONS, 2009 EDITION. ALL STRIPES SHALL BE PAINTED IN ACCORDANCE WITH THE SPECIFICATIONS FOR PAINTED STRIPES AND MARKINGS PER CALTRANS STANDARD PLANS AND SPECIFICATIONS, 2009 EDITION.
6. ALL PAVED SURFACES SHALL BE MAINTAINED TO THE CITY STANDARDS FOR PAVED SURFACES PER CALTRANS STANDARD PLANS AND SPECIFICATIONS, 2009 EDITION.
7. ALL PAVED SURFACES SHALL BE MAINTAINED TO THE CITY STANDARDS FOR PAVED SURFACES PER CALTRANS STANDARD PLANS AND SPECIFICATIONS, 2009 EDITION.
8. ALL PAVED SURFACES SHALL BE MAINTAINED TO THE CITY STANDARDS FOR PAVED SURFACES PER CALTRANS STANDARD PLANS AND SPECIFICATIONS, 2009 EDITION.
9. ALL PAVED SURFACES SHALL BE MAINTAINED TO THE CITY STANDARDS FOR PAVED SURFACES PER CALTRANS STANDARD PLANS AND SPECIFICATIONS, 2009 EDITION.
10. ALL PAVED SURFACES SHALL BE MAINTAINED TO THE CITY STANDARDS FOR PAVED SURFACES PER CALTRANS STANDARD PLANS AND SPECIFICATIONS, 2009 EDITION.
11. ALL PAVED SURFACES SHALL BE MAINTAINED TO THE CITY STANDARDS FOR PAVED SURFACES PER CALTRANS STANDARD PLANS AND SPECIFICATIONS, 2009 EDITION.
12. ALL PAVED SURFACES SHALL BE MAINTAINED TO THE CITY STANDARDS FOR PAVED SURFACES PER CALTRANS STANDARD PLANS AND SPECIFICATIONS, 2009 EDITION.
13. ALL PAVED SURFACES SHALL BE MAINTAINED TO THE CITY STANDARDS FOR PAVED SURFACES PER CALTRANS STANDARD PLANS AND SPECIFICATIONS, 2009 EDITION.
14. ALL PAVED SURFACES SHALL BE MAINTAINED TO THE CITY STANDARDS FOR PAVED SURFACES PER CALTRANS STANDARD PLANS AND SPECIFICATIONS, 2009 EDITION.
15. ALL PAVED SURFACES SHALL BE MAINTAINED TO THE CITY STANDARDS FOR PAVED SURFACES PER CALTRANS STANDARD PLANS AND SPECIFICATIONS, 2009 EDITION.
16. ALL PAVED SURFACES SHALL BE MAINTAINED TO THE CITY STANDARDS FOR PAVED SURFACES PER CALTRANS STANDARD PLANS AND SPECIFICATIONS, 2009 EDITION.
17. ALL PAVED SURFACES SHALL BE MAINTAINED TO THE CITY STANDARDS FOR PAVED SURFACES PER CALTRANS STANDARD PLANS AND SPECIFICATIONS, 2009 EDITION.
18. ALL PAVED SURFACES SHALL BE MAINTAINED TO THE CITY STANDARDS FOR PAVED SURFACES PER CALTRANS STANDARD PLANS AND SPECIFICATIONS, 2009 EDITION.
19. ALL PAVED SURFACES SHALL BE MAINTAINED TO THE CITY STANDARDS FOR PAVED SURFACES PER CALTRANS STANDARD PLANS AND SPECIFICATIONS, 2009 EDITION.
20. ALL PAVED SURFACES SHALL BE MAINTAINED TO THE CITY STANDARDS FOR PAVED SURFACES PER CALTRANS STANDARD PLANS AND SPECIFICATIONS, 2009 EDITION.
21. ALL PAVED SURFACES SHALL BE MAINTAINED TO THE CITY STANDARDS FOR PAVED SURFACES PER CALTRANS STANDARD PLANS AND SPECIFICATIONS, 2009 EDITION.

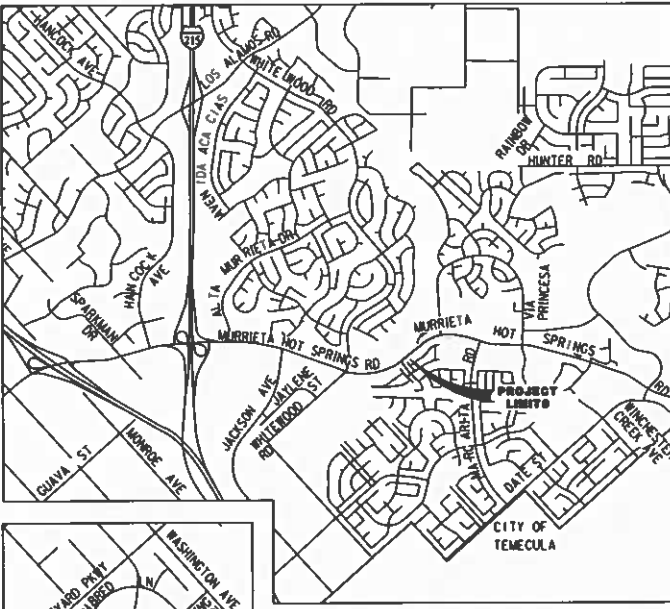

**SIGNING AND STRIPING GENERAL NOTES CONTINUED:**

22. ALL SIGNING SHALL BE IN ACCORDANCE WITH THE SPECIFICATIONS FOR SIGNING PER CALTRANS STANDARD PLANS AND SPECIFICATIONS, 2009 EDITION.
23. ALL SIGNING SHALL BE IN ACCORDANCE WITH THE SPECIFICATIONS FOR SIGNING PER CALTRANS STANDARD PLANS AND SPECIFICATIONS, 2009 EDITION.
24. ALL SIGNING SHALL BE IN ACCORDANCE WITH THE SPECIFICATIONS FOR SIGNING PER CALTRANS STANDARD PLANS AND SPECIFICATIONS, 2009 EDITION.

**NOTE:**  
WATER AND GAS TAPES AND HANDS COVERED UNDER ARE FOR UTILITY FACILITY MARKS. ALL GAPS AND GAPS MAY BE SPONSOR CONTRACTOR SHALL LOCATE AND THE CUT ALL GAPS AND GAPS PRIOR TO ANY REHABILITATION WORK. WATER AND GAS TAPES SHALL BE MARKED TO BE MADE AFTER WORK IS COMPLETED. WATER AND GAS TAPES SHALL BE MARKED TO BE MADE AFTER WORK IS COMPLETED. WATER AND GAS TAPES SHALL BE MARKED TO BE MADE AFTER WORK IS COMPLETED.

**WORK TO SHEETS**

WORK NO.	DESCRIPTION
1	TITLE SHEET
2	GENERAL SHEET
3 - 4	PAVING PLANS MURRIETA HOT SPRINGS ROAD
5 - 6	SIGNING AND STRIPING PLANS MURRIETA HOT SPRINGS ROAD

**"DECLARATION OF RESPONSIBLE CHARGE"**  
I HEREBY DECLARE THAT I AM THE ENGINEER OF RECORD FOR THIS PROJECT. I HAVE EXERCISED REASONABLE CARE AND SKILL IN THE DESIGN OF THIS PROJECT AND THAT THE DESIGN IS CONSISTENT WITH CURRENT STANDARDS. I UNDERTAKE THAT THE CHECKS OF PROJECT DRAWINGS AND SPECIFICATIONS BY THE CITY OF MURRIETA IS CONFINED TO A REVIEW ONLY AND DOES NOT RELIEVE ME, AS ENGINEER OF RECORD, OF MY RESPONSIBILITIES FOR PROJECT DESIGN.

CITY OF MURRIETA  
12000 WINDYBROOK  
MURRIETA, CA 92562  
PROJECT NO. 24-485  
DATE: 5/23/24  
BY: [Signature]  
C.E.C. NO. 99999



**NOTICE TO CONTRACTORS**  
All contractors and subcontractors performing work shown or related to these plans shall conform to all applicable laws and regulations and shall be held liable for any and all violations. All contractors and subcontractors shall comply with the "Occupational Safety and Health Administration (OSHA) Safety Program" and the "California Department of Industrial Relations (CDIR) Safety Program". The contractor shall be responsible for any and all violations of these laws and regulations. The contractor shall be responsible for any and all violations of these laws and regulations. The contractor shall be responsible for any and all violations of these laws and regulations.

**NO B.B.P.**  
The amount of work done and days completed thereof are not due to the Sub-contractor of any responsibility for any errors.

Engineer of work: [Signature] Date: [Date]  
REV: [Date] EXP: [Date]

Contractor: [Signature] Date: [Date]  
REV: [Date] EXP: [Date]

NO.	DESCRIPTION	DATE
1	TITLE SHEET	5/23/24
2	GENERAL SHEET	5/23/24
3	PAVING PLANS MURRIETA HOT SPRINGS ROAD	5/23/24
4	SIGNING AND STRIPING PLANS MURRIETA HOT SPRINGS ROAD	5/23/24

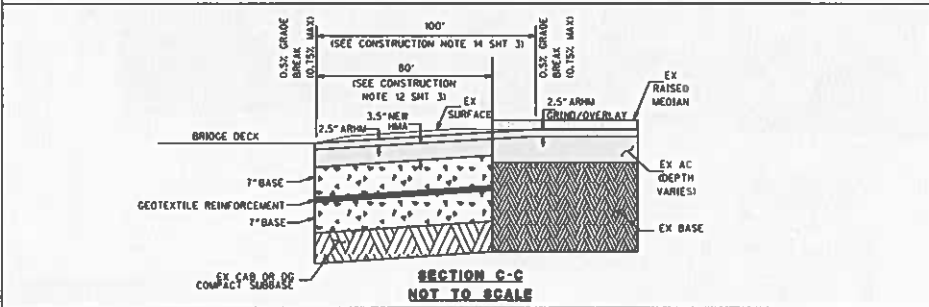
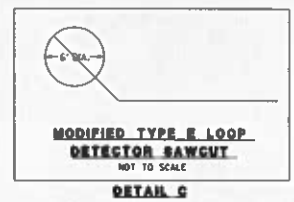
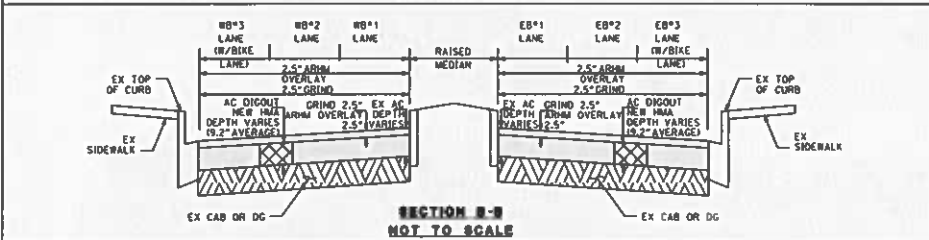
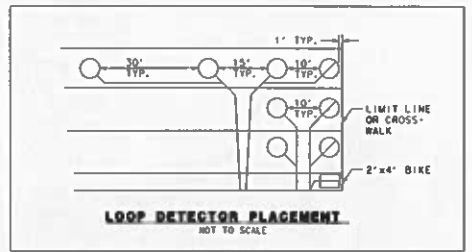
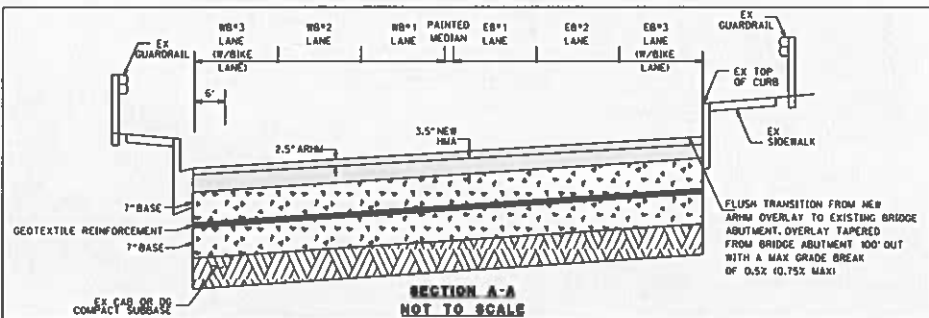

**DETAIL A**

**16 627**  
The recipient of At-Bid Plans and Specifications assumes their use  
under the liability/obligation of any responsibility for their accuracy.  
Engineer of work: \_\_\_\_\_ Date: \_\_\_\_\_  
REC: \_\_\_\_\_ EIP: \_\_\_\_\_



NO.	DATE	BY	CHKD.	APP'D.	DESCRIPTION

NO.	<b>5</b>	<b>CITY OF BURNETTVA</b>	NO.	<b>6</b>
		<b>CONSTRUCTION</b>		
<b>DETAIL SHEET</b>				
<b>PAVEMENT REHABILITATION PROJECT</b>				
<b>BURNETTVA HOT SPRINGS ROAD</b>				
<small>PROJECT NO. 2019-01-001            CONTRACT NO. 24-03            SHEET NO. 24-03</small>				



**LEGEND**

TRAFFIC SIGNAL	⊗
CENTERLINE MONUMENT	●
EXISTING WATER VALVE CAN	▲
EXISTING MANHOLE	⊙
EXISTING CURB OF SEWER	—
PROPOSED AND EXISTING S.C.	▨
POLE TO CONDUIT CONNECTION	⊥
CONDUIT TO CONDUIT CONNECTION	—
REPAIR/REPLACE CONDUITS	⊠

**NOTE:**  
WATER AND GAS VALVE CANS AND MANHOLE COVERS SHOWN ARE PER UTILITY FACILITY MAPS. HOT GAS CANS ARE COVERED UNTIL SHEET CONTRACTOR SHALL LOCATE AND SET ALL CANS AND COVERS PRIOR TO ANY REHABILITATION WORK. WATER AND GAS VALVE CANS SHALL BE MARKED TO CHASE AFTER WORK IS COMPLETED. BEFORE A COVER OR CAN CAN BE IN PLACE CONTRACTOR TO COORDINATE WITH RESPECTIVE UTILITY COMPANY AND INSTALL NEW VALVE CAN PROVIDED BY UTILITY. STORM DRAIN MANHOLES SHALL BE MARKED TO CHASE.

**NOTE:**  
CONTRACTOR SHALL REMOVE PLANTING/VEGETATION ALONG OUTER L.P. THROUGHOUT PROJECT LIMITS AS PART OF STREET SHEETING.

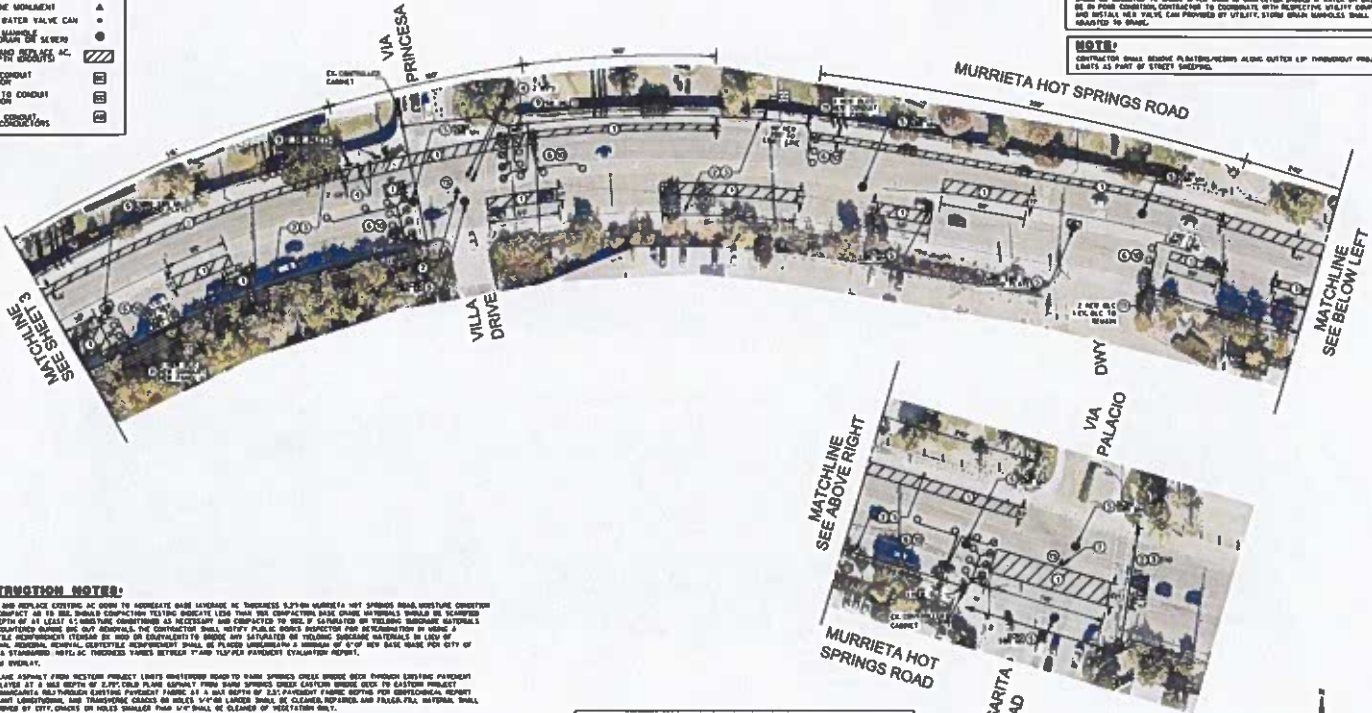

**CONSTRUCTION NOTES:**

- REMOVE AND REPLACE EXISTING AC CURB TO ADEQUATE BASE MINIMUM AC THICKNESS 3.25 IN. MURRIETA HOT SPRINGS ROAD. MIXTURE CONDITION AND RECOMPACT AS IS. SEE SHOWN CONSTRUCTION DETAILS INDICATE LANE THAT THE CONTRACTOR BASE CHANGE MATERIALS SHOULD BE RECOMPACTED TO A DEPTH OF AT LEAST 12 INCHES. CONSTRUCTION AS NECESSARY AND COMPACTED TO 95% OF STANDARD OF TESTING. BARRIER MATERIALS AND UNCOMPACTED SAND AND GRAVELS. THE CONTRACTOR SHALL NOTIFY PUBLIC WORKS INSPECTOR FOR RECONSTRUCTION IN WORK A SCHEDULED INSPECTION TIME AND IN CONFORMANCE TO ANY SCHEDULED OR TESTING. SCHEDULE MATERIALS TO LANE OF RECONSTRUCTION. REPAIR/REPLACE CONDUITS SHALL BE PLACED UNDERMINING A MINIMUM OF 6" OF NEW BASE GRADE PER CITY OF MURRIETA STANDARDS. NOTIFY ALL UTILITIES THROUGH T-1 AND T-2 PER STANDARD EVALUATION REPORT.
- 2.5" DRAIN OVERLAY.
- 2.0" PLANE ASPHALT FROM EXISTING PROJECT LIMITS OUTSIDE ROAD TO 2.0" SPONGE DRESS MIXTURE SEEN THROUGH EXISTING PAVEMENT. FINEB LAYER AT A MAX DEPTH OF 1.5". 1.5" PLANE ASPHALT FROM SAND SPONGE DRESS LAYER SEEN TO EXISTING PROJECT LIMITS. EQUIVARIANT BOLD THROUGH EXISTING PAVEMENT AS A MAX DEPTH OF 2.5" PAVEMENT FINEB LAYER PER STRUCTURAL REPORT. SCHEDULE INSPECTION AND TESTING. CRACKS OR HOLES 1/4" OR LARGER SHALL BE CLEANED, REPAIRED, AND PATCHED. PATCHES SHALL BE APPROVED BY CITY. CRACKS OR HOLES SMALLER THAN 1/4" SHALL BE CLEANED OR REPAIRED ONLY.
- REMOVE WATER OR GAS VALVE CAN TO CHASE AS NEEDED.
- REMOVE EXISTING WATER MANHOLE/UTILITY TO CHASE.
- REPLACE LOOP DETECTORS PER DETAILS G AND C ON SHEET 2.
- LOCATE AND TIE OUT EXISTING MANHOLE. INSTALL NEW CENTERLINE MONUMENT PER CDR. SEE RD 617D AND 617C.
- PROTECT IN PLACE.
- PROTECT TO INSTALLATION OF 1.0" CURB. CONTRACTOR TO COORDINATE WITH CITY REPAIRS FOR LAYOUT/PLACEMENT OF LOOPS.
- FURNISH AND INSTALL 12" PALMADA CONDUIT AND LOOP STUD-ON. NEW FANED AND LOOP FORMS AS SHOWN. REMOVE EXISTING S.C. AND FURNISH AND INSTALL NEW S.C. 12" FROM ADVANCE LOOPS TO CONTROLLED CABINET. REPAIR HOT CONCRETE/REPAIRABLE PANELS IN CURB.

**NOTE:**  
ONLY NIGHT WORK SHALL BE ALLOWED ON MURRIETA HOT SPRINGS ROAD. NIGHT WORK SHALL BE BETWEEN 5 P.M. AND 5 A.M.



NO B.B.T.  
By design of the City of Murrieta and City Engineer. This plan is subject to the approval of the City Engineer. The City Engineer is not responsible for the accuracy of the information shown hereon.

Engineer of work: \_\_\_\_\_ Date: \_\_\_\_\_  
City: \_\_\_\_\_

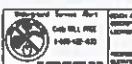

NO.	DATE	REVISION DESCRIPTION	BY	CHK.	APP.

CITY OF MURRIETA		NO. 6
ENGINEERING DEPARTMENT		NO. 6
<b>PAVING PLAN</b>		
<b>PAVEMENT REHABILITATION PROJECT</b>		
<b>MURRIETA HOT SPRINGS ROAD</b>		
DATE: 11/12/2013		
DESIGNER: J. SMITH	CHECKED: J. SMITH	PROJECT NO.: 24-000
DATE: 11/12/2013	DATE: 11/12/2013	SHEET NO.: 24-430



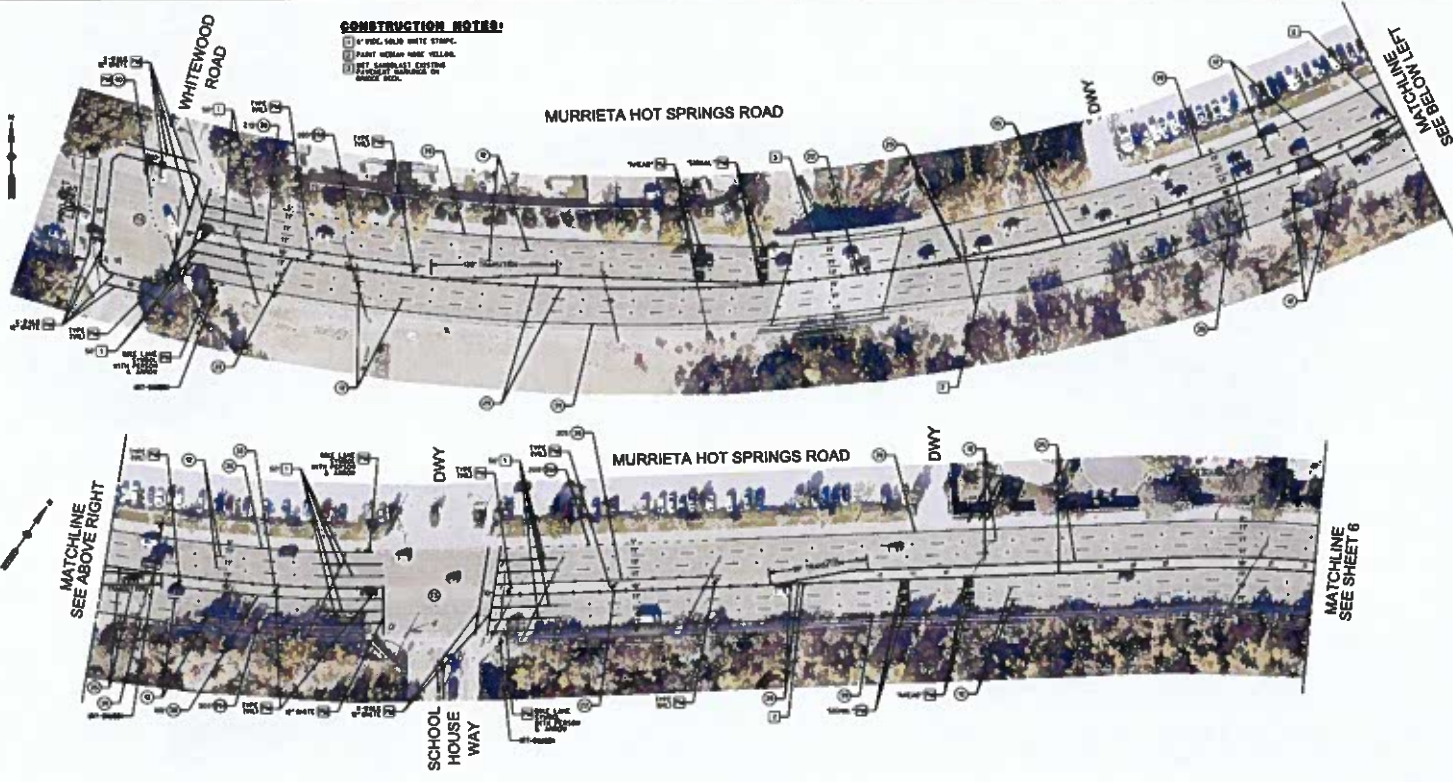

**EXISTING SIGN LEGEND**

87-50000

**LEGEND**

TRAFFIC SIGNAL

STAMPING DETAIL NO.

THROUGH LANE

PROPOSED SIGN

EXISTING SIGN

210

210-1

210-2

NO BIDDY

The intent of All-Bid Plans and Specifications shall be to provide the Bidder/Contractor of any responsibility for their accuracy.

Engineer of work: \_\_\_\_\_ Date: \_\_\_\_\_

City: \_\_\_\_\_

**APPROVED**

PROJECT NO. \_\_\_\_\_

DATE OF APPROVAL: \_\_\_\_\_

APPROVED BY: \_\_\_\_\_

APPROVED FOR: \_\_\_\_\_

NO.	DESCRIPTION	DATE	BY

GRAPHIC SCALE 1" = 40'

DATE	CITY OF MURRIETA	SHEET
0	Public Works Department	0

**DESIGN AND STRIPING PLAN**

**PAVEMENT RENOVATION PROJECT**

**MURRIETA HOT SPRINGS ROAD**

PROJECT NO. 2014-0001

DATE: 08/25/14

DESIGNED BY: JAMES L. JONES, JR.

CHECKED BY: JAMES L. JONES, JR.

DATE: 08/25/14

PROJECT NO. 2014-0001

SHEET NO. 0

Project: Pavement Renovation - Murrieta Hot Springs Road  
 Date: 08/25/14  
 Scale: 1" = 40'  
 Author: JAMES L. JONES, JR.  
 Checker: JAMES L. JONES, JR.  
 Date: 08/25/14

**CONSTRUCTION NOTES:**

- 1) 1" WHEEL BODILY DAMAGE SYMBOL
- 2) PAINT MARKING MADE FIELD OR.

LEGEND	
	TRAFFIC SIGN
	STRIPING DETAIL NO.
	NARROWED PAVEMENT
	PROPOSED SIGN
	EXISTING SIGN

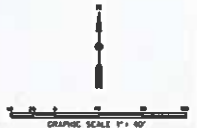
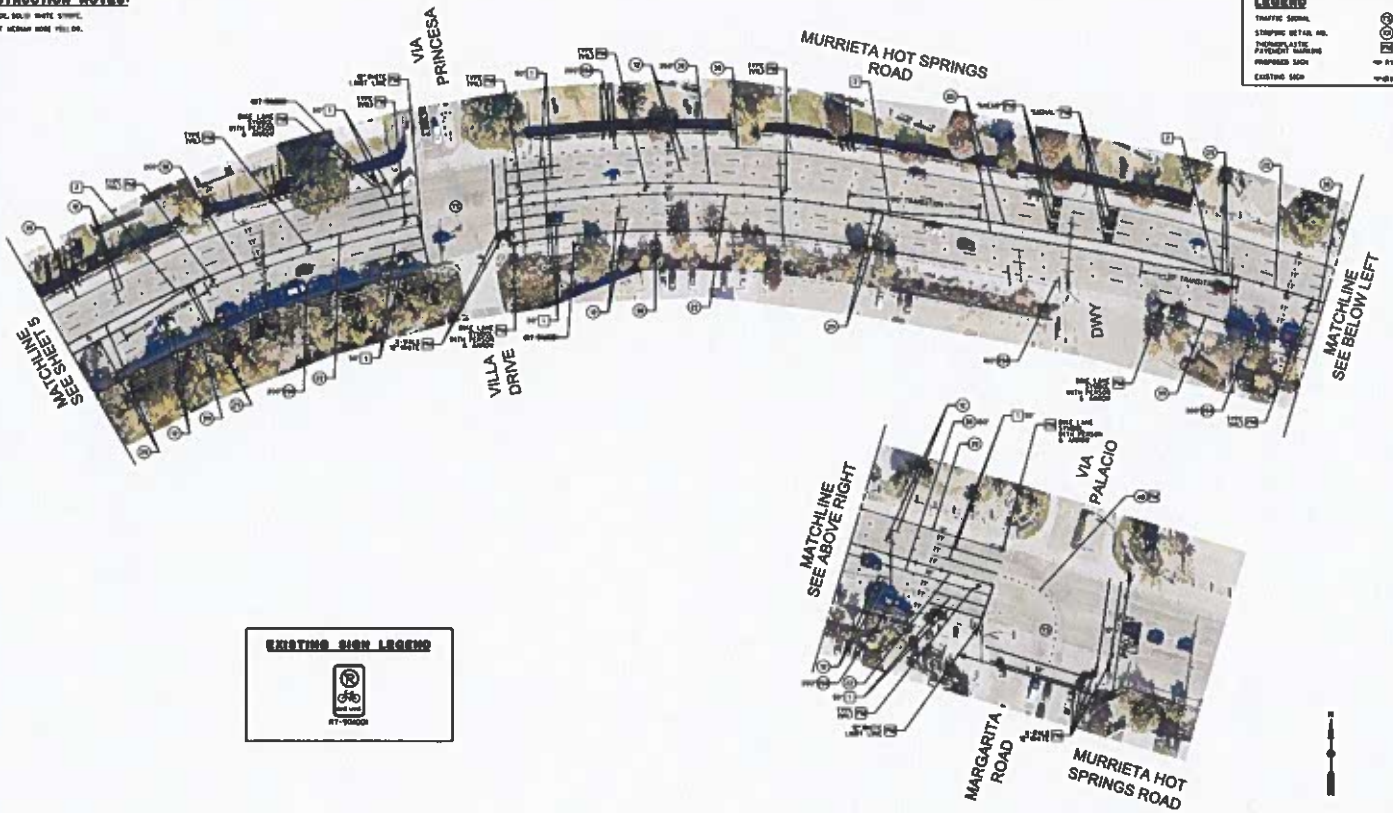

<p><b>15 DAY</b> The receipt of this plan by City employees shall not constitute the City's acceptance of any responsibility for their contents.</p> <p>Engineer of work: _____ Date: _____          City Engineer: _____ Date: _____</p>		<p><b>REVISIONS</b></p> <table border="1"> <tr> <th>NO.</th> <th>DESCRIPTION</th> <th>DATE</th> </tr> <tr> <td> </td> <td> </td> <td> </td> </tr> <tr> <td> </td> <td> </td> <td> </td> </tr> </table>	NO.	DESCRIPTION	DATE							<p><b>CITY OF MURRIETA</b>          ENGINEERING DIVISION</p> <p><b>STREET AND STRIPING PLAN          PAVEMENT RENOVATION PROJECT          MURRIETA HOT SPRINGS ROAD</b></p> <p>DESIGNED BY: _____ CHECKED BY: _____          DRAWN BY: _____ DATE: _____</p> <p>PROJECT NO.: 24-100          SHEET NO.: 24-100-1</p>
NO.	DESCRIPTION	DATE										

No part of this drawing may be reproduced or transmitted in any form or by any means electronic or mechanical, including photocopying, recording, or by any information storage and retrieval system, without the prior written permission of the City of Murrieta.